

REPUBLIC OF MAURITIUS

Department of Civil Aviation  
Sir Seewoosagur Ramgoolam  
International Airport  
Plaine Magnien  
MAURITIUS



Tel. : (230) 6032000  
Fax : (230) 6373164  
Email : [civil-aviation@govmu.org](mailto:civil-aviation@govmu.org)  
Website : [civil-aviation.govmu.org](http://civil-aviation.govmu.org)

AVIATION SECURITY DIRECTIVE

EXTERNAL REFERENCE	DISTRIBUTION PER DISTRIBUTION LIST
DEPT REF : CAV/CASU/1/1	Directive No: ASD 01 of 2022
<b>VALIDITY:</b> With effect from 15hr00 on Friday 08 April 2022 this ASD repeals and replaces ASDs 02 and 03 of 2021 and will be valid until further notice.	<b>Issue Date: 08 April 2022</b>

**Subject: Modifications of the Security Restricted Area and Re-establishment of the Departure Staff Passage Screening Check Point at Level 1 of the Terminal Building at Sir Seewoosagur Ramgoolam International Airport.**

**1.0 Purpose of the Aviation Security Directive**

1.1 This Aviation Security Directive is issued pursuant to provisions of Regulations 27 and 42 of the Civil Aviation (Security) Regulations 2019 for guidance and necessary actions to be taken in respect of modification of the Security Restricted Area (SRA) and re-establishment of the departure staff passage Screening Check Point (SCP) at Level 1 of the Terminal Building at Sir Seewoosagur Ramgoolam International Airport.

**2.0 Modification of Security Restricted Area**

2.1 With effect from 15hr00 on Friday 08 April 2022, part of the area which was removed from the SRA, vide ASDs 02 and 03 of 2021 in view of construction works, will be reinstated in the SRA. The new SRA boundary at Level 1 will be realigned as shown in the drawing attached to this directive.

2.2 The new SRA alignment is indicated by the red line which runs from the existing point P1 through new points at P2, P3, P4, P5, P6, P7, P8, P9, P10, P11, P12, P13, P14, P15 and ends at existing point P16. The coordinates of the new SRA line are described in the attached drawing.

### **3.0 Re-establishment of departure staff passage Security Check Point**

- 3.1 The temporary departure staff passage which was set up vide ASD 02 of 2021 will continue to be used for access to the SRA (sterile area) by authorised staff until 12hr00 on Monday 11 April 2022. Subsequently, after 12hr00 on Monday 11 April 2022, holders of a valid ASIC shall be allowed access to the SRA (Sterile area) through Door labelled A, which is equipped with a Security Access Control System (SACS), at the re-established departure staff passage SCP, as can be depicted in the attached drawing. Airport Police shall control access through door labelled A which gives access from landside to the airside/SRA. AML shall ensure that authorized staff seeking access to the sterile area are directed towards Door labelled A.
- 3.2 Door labelled C shall be used by authorized Aviation Security Identification Card (ASIC) holders to exit the airside/SRA (sterile area). Door labelled C has a landside/airside interface and is fitted with SACS. The door also includes an airlock system, consisting of two interlocking doors. ASIC holders are advised to follow the instructions indicated on the mode of operation notice affixed at the access control door. Airport Police shall ensure that access to the airside/SRA is not allowed through Door labelled C.
- 3.2.1 In the event the airlock system is unserviceable, Airport Police shall control access at Door labelled C and ensure that access to the airside/SRA is not allowed. During intervention on Door labelled C, for the purpose of repairs/maintenance (such that it would be impracticable/unsafe to use the door for staff exit), Door labelled D shall be used as an alternate staff exit (from the departure sterile area). AML shall hand over keys of Door labelled D to Police. During intervention on Door labelled C, for the purpose of repairs/maintenance, AML shall supervise maintenance/repairs works to the airlock system to ensure that unauthorised access to the SRA through Door labelled C is not allowed.
- 3.2.2 Prior to use of Door labelled D, as mentioned at section 3.2.1 above, AML shall coordinate with Airport Police and MRA-Customs. Airport Police shall ensure that access to the SRA through door labelled D is not allowed.
- 3.3 In order to exercise control over movement of persons to and from the Customs controlled area (as indicated in the attached drawing), a Security Access Control System has been installed at Door labelled B.
- 3.4 AML shall ensure that relevant signage are in place to guide staff accessing and exiting the Departure Sterile Area.
- 4.0 Non-compliance shall entail judicial proceedings.

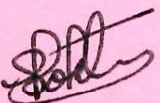

**I POKHUN**  
**Director of Civil Aviation**

**ATTACHMENT TO ASD 01 OF 2022  
DEPARTURE STAFF PASSAGE & EXIT LEVEL 1**

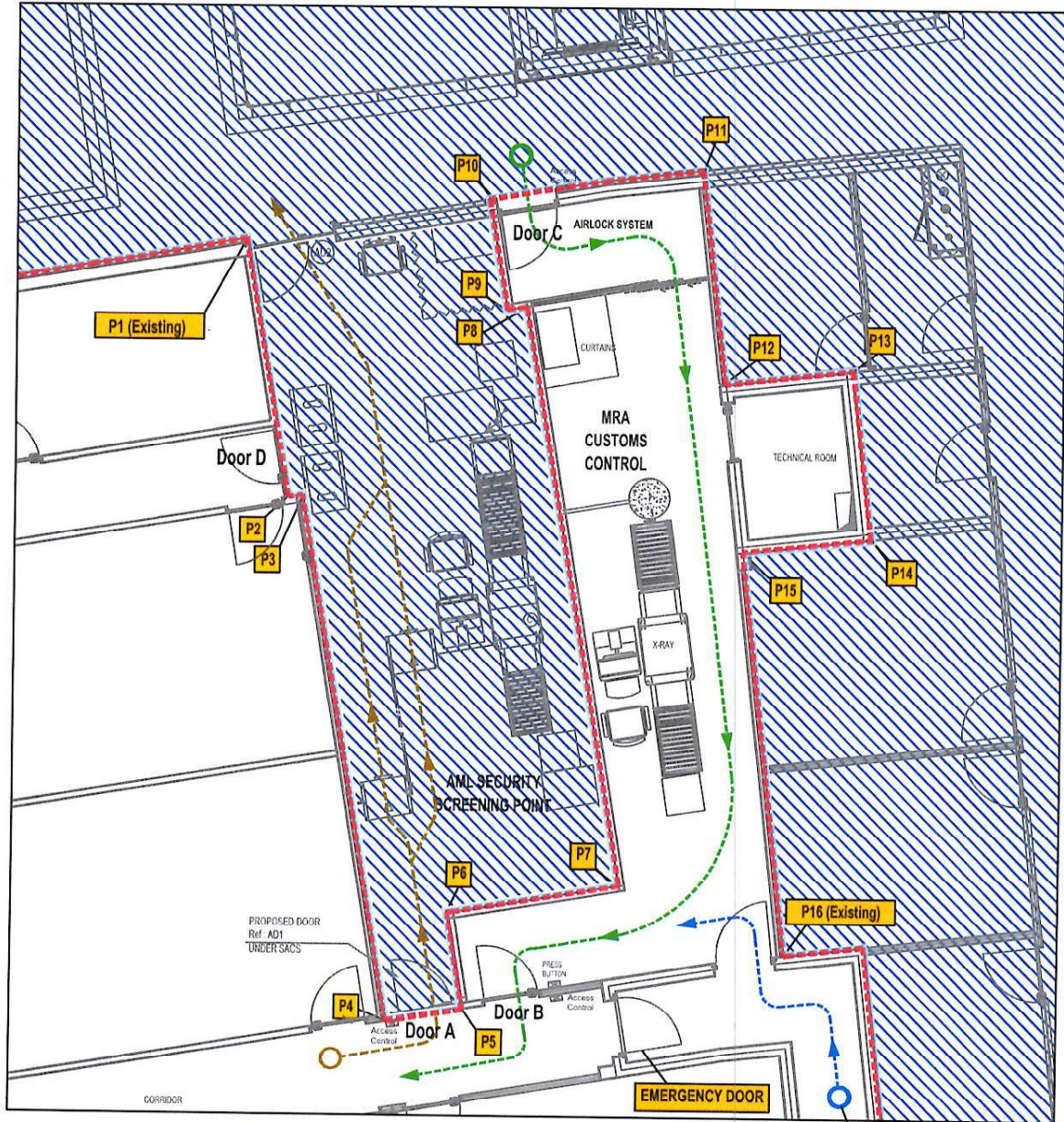

NEW COORDINATES FOR STAFF EXIT AREA		
POINT No.	EASTINGS	NORTHINGS
P1 (existing)	1015639.976	973992.574
P2	1015636.327	973989.923
P3	1015636.460	973989.744
P4	1015629.021	973984.307
P5	1015629.788	973983.252
P6	1015631.149	973984.217
P7	1015632.903	973981.806
P8	1015641.049	973987.756

NEW COORDINATES FOR STAFF EXIT AREA		
POINT No.	EASTINGS	NORTHINGS
P9	1015640.915	973988.023
P10	1015642.443	973989.161
P11	1015644.556	973986.093
P12	1015641.457	973984.101
P13	1015642.636	973982.232
P14	1015640.158	973980.650
P15	1015638.985	973982.506
P16 (existing)	1015633.139	973978.738

Exit from level 2

**LEGEND**

- - - - SRA LINE
- SRA